

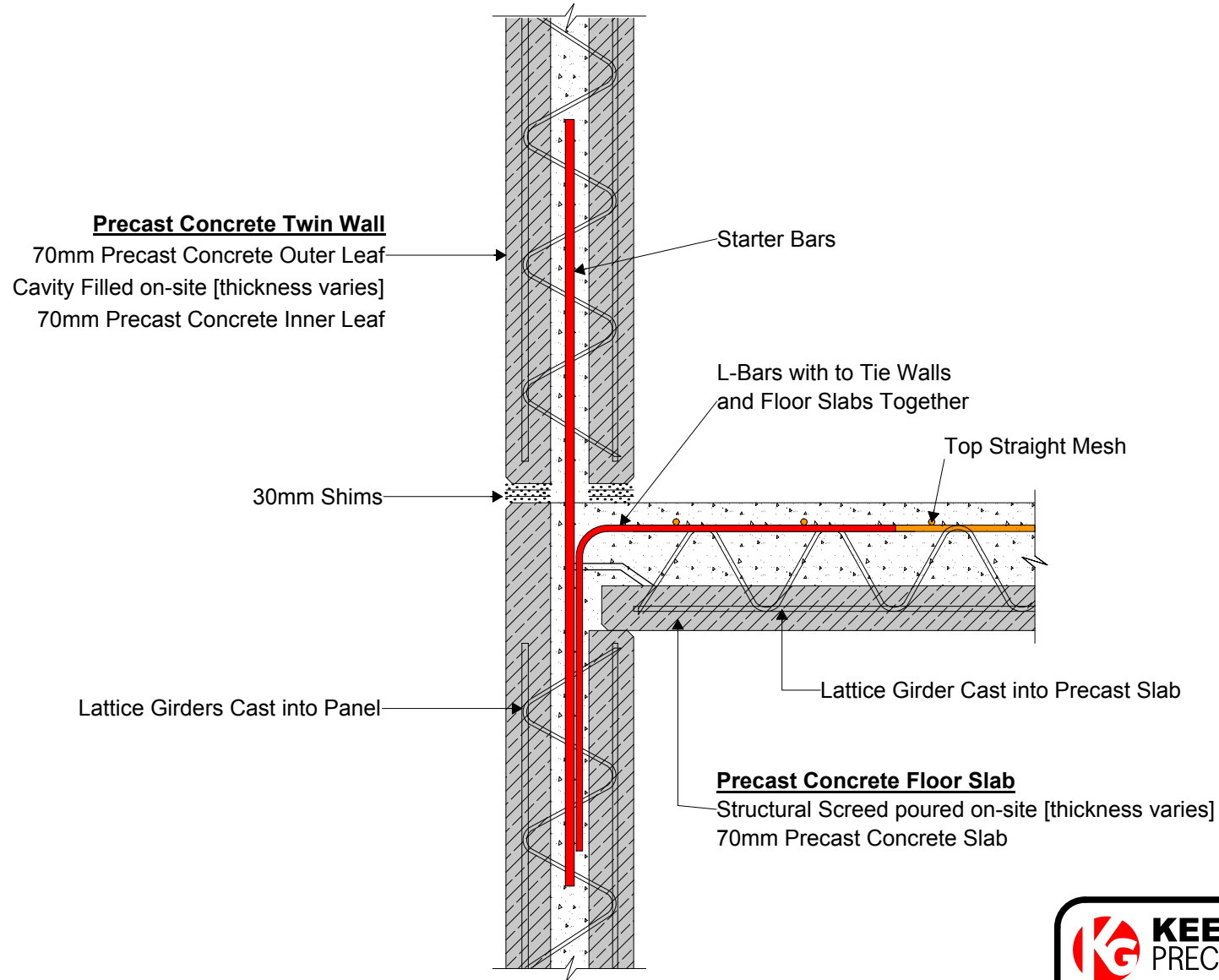

# TW109 - External Wall to Wall



 <b>KEEGAN PRECAST</b> PRECAST TWIN WALL & FLOOR PRODUCTS	Trammon, Rathmolyon, Co. Meath IRL Tel: +353 (0)46 95 55116 UK Tel: +44 (0)131 516 7507 +44 (0)203 432 4901 Email: info@keeganprecast.com	
	Type: <b>Typical Precast Twin Wall Details</b>	Detail: <b>TW109 - External Wall to Wall</b>
Drawn by: <b>MT</b>	Date: 30/01/2017	Scale: 1:10