

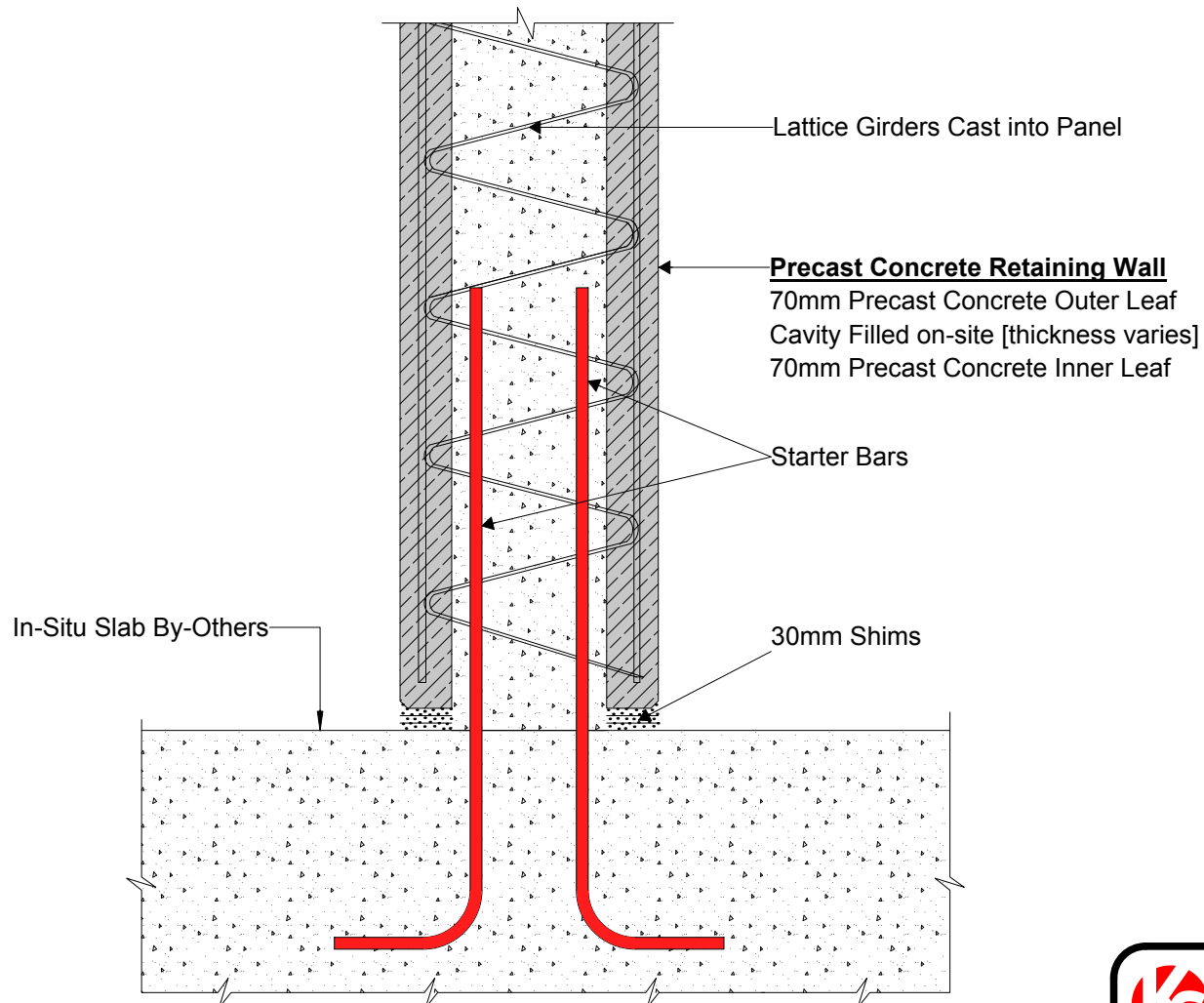

TW111 - Retaining Wall Base with Starter Bars



 KEEGAN PRECAST PRECAST TWIN WALL & FLOOR PRODUCTS	Trammon, Rathmolyon, Co. Meath IRL Tel: +353 (0)46 95 55116 UK Tel: +44 (0)131 516 7507 +44 (0)203 432 4901 Email: info@keeganprecast.com	
	Type:	Typical Precast Twin Wall Details
Detail:	TW111 - Retaining Wall Base with Starter Bars	
Drawn by: MT	Date: 02/03/2017	Scale: 1:10